

The information contained in this drawing is the sole property of CWS Coil Winding Specialist. Any reproduction in part or whole without written permission of CWS Coil Winding Specialist is prohibited.

REVISION HISTORY

REV	ECN	DESCRIPTION	SIGN & DATE		
			BY	DATE	DATE
B		PRODUCTION RELEASE	TDK	5/15/06	5/15/06

VERTICAL CONFIGURATION

.18 [4.58]

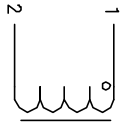

SCHEMATIC

HORIZONTAL CONFIGURATION

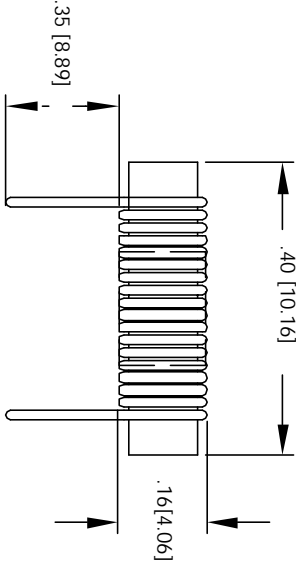

FRONT VIEW

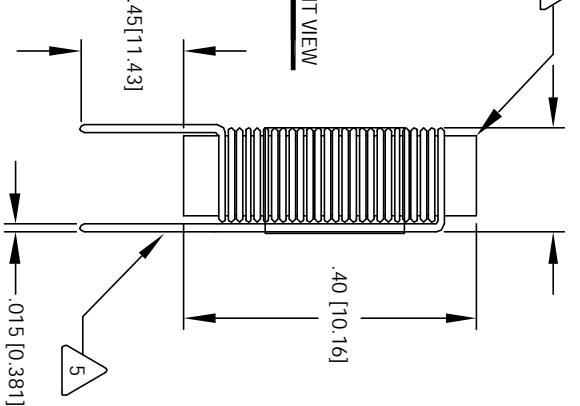

FRONT VIEW

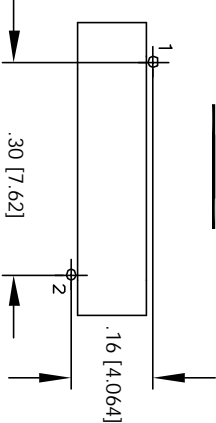

MOUNTING HOLES PATTERN

- 6 BUILT TO ROHS COMPLIANCE AND LEAD FREE.
- LEADS MUST BE TANGENT TO THE CORE FLUSH WITH THE CORE EDGE, AS SHOWN
- 5 REMOVE INSULATION AND TIN LEADS
- WIND COILS EVENLY SPACED
- CONSTRUCTION:
- HI-POT TEST FOR CORE TO WINDING = 500 VDC
- DCR = 34.10 MILLI-OHMS @ 25 °C
- L = 3.3 UH ± 20% , 1 KHz, 0.25 Vrms, 0 ADC;
- SPECIFICATIONS: MAX DC CURRENT = 1 AMPS



WIRE: UL RECOGNIZED 130° RATED MAGNET WIRE

CWS BYTEMARK OR OTHER APPROVED PART

CORE: MANGANESE ZINC FERRITE ROD

- 1 MATERIAL: WIRE INSULATION - UL RECOGNIZED 94V-0 FOR FLAMMABILITY
- RATING CLASS B (130°) REQUIRED

NOTES: UNLESS OTHERWISE SPECIFIED, POWER INDUCTOR, DIMENSIONS IN INCHES [MM]

READ FROM BOTTOM UP.

CODE	IDENT	MFG. P/N	DESCRIPTION	ITEM NO.
PARTS LIST				
AUTOCAD	X			
SOLIDWORKS				
SIGN	DATE			
TDK	5/15/06			
DEVID	5/15/06			
ENGR.	5/15/06			
APPR.	5/15/06			
JLJU	5/15/06			
SIZE	DATE			
B	5/15/06			
SCALE	2=1			
SHEET	1			
OF	1			